

EISFABRIKBERLIN

PLACE: BERLIN ICE FACTORY BETWEEN KOPERNICKERSTRASSE AND SPREE RIVER



FABRIK



THE EISFABRIK IS AN ABANDONED STRUCTURE SANDWICHED BETWEEN KOPERNICKER STRASSE ON ONE SIDE, AND THE SPREE RIVER ON THE OTHER. THE EISFABRIK EXISTS NOT JUST AS AN ARTEFACT DIRECTLY REPRESENTING BERLIN'S INDUSTRIAL PAST, BUT ALSO AS A KIND OF POST-URBAN REPRESENTATION OF THE CITY'S IDENTITY TODAY.

LIFE

THE EISFABRIK (ICE FACTORY) WAS ONE OF THE OLDEST ICE FACTORIES IN GERMANY. IT OPENED ITS DOORS IN 1896 NEXT TO THE RIVER ON KÖPENICKERSTRASSE 40/41. IN THE TIME WHEN REFRIGERATORS DID NOT EXIST, THE ICE THAT WAS PRODUCED WOULD BE DELIVERED ALL OVER BERLIN TO BREWERIES, PUBS, HOMES, ETC.. LA FABBRICA DI GHIACCIO, UNA DELLE PIÙ ANTICHE IN GERMANIA, APRÌ NEL 1896 E IN UN'EPOCA IN CUI NON ESISTEVANO FRIGORIFERI, IL GHIACCIO PRODOTTO AVREBBE RIFORNITO TUTTA BERLINO.



1896

THE EISFABRIK MANAGED TO SURVIVE MANY DAMAGES, SEVERAL FIRES AND BOMBS THROUGHOUT ITS LIFESPAN. IN 1914 THE FACTORY CHIMNEY COLLAPSED AND MADE THE HEADLINES IN THE NEWS. IN 1945 THE HOUSES NEXT TO THE FACTORY WHICH WERE OWNED BY THEM AS WELL WERE BOMBED TO THE GROUND DURING THE WAR. DURANTE IL SUO PERIODO DI ATTIVITÀ LA FABBRICA SOPRAVVISSE A INCENDI E BOMBARDAMENTI CHE LA COLPIRONO NEL 1914 E POI NEL 1945.



1945

AFTER THE GERMAN REUNIFICATION, HOWEVER, THERE WAS NO MORE DEMAND FOR THE ICE BLOCKS AND SO THE FACTORY GOT CLOSED DOWN A YEAR AFTER. THERE HAS BEEN A FIRE IN 1995 AND THE COLD STORAGE WAREHOUSES WERE DEMOLISHED IN 2010. L'ANNO SEGUENTE ALLA RIUNIFICAZIONE DELLA GERMANIA LA FABBRICA VENNE CHIUSA, CAUSA LA MANCANZA DI DOMANDA DI GHIACCIO. NEL 1995 FU COLPITA DA UN INCENDIO E NEL 2010 L'ALA DI CONSERVAZIONE FRIGORIFERA VENNE DEMOLITA.



1995

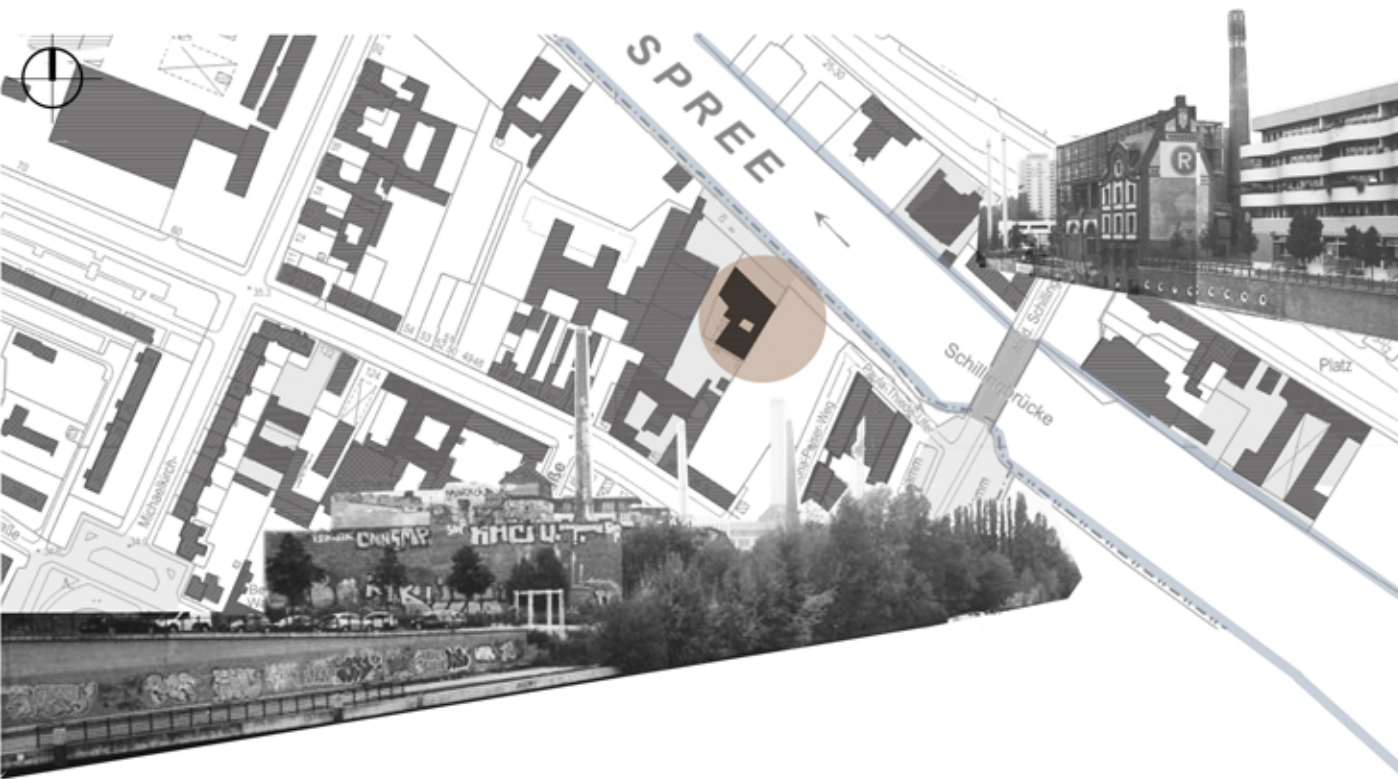

GROUND FLOOR PLAN SCALE 1:100

CONCEPT

ARCHITECTURE FOR MAN

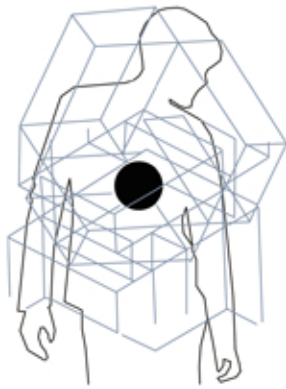

WHY: BERLIN ICE FACTORY INSIDE CITY AND OUTSIDE SOCIETY

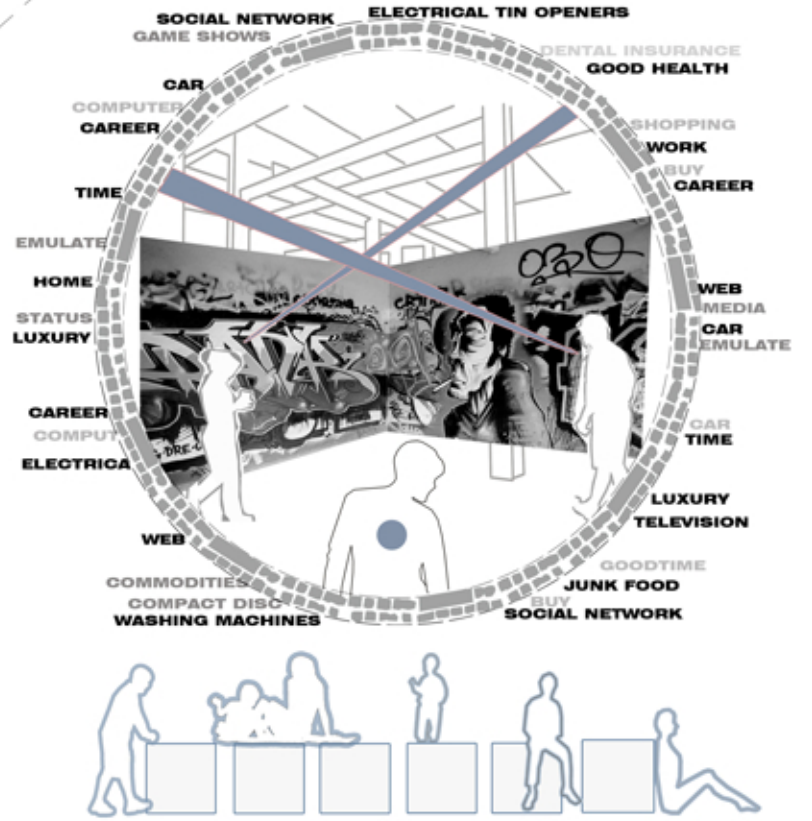

CYCLE



2012

ON THE MAIN FLOOR OF THE FACTORY YOU'LL SEE THE BIG ICE MACHINE THAT MADE THE MAGIC HAPPEN. ALSO THERE ARE SMALLER ROOMS IF YOU GO UP TO THE FLOORS AND EXPLORE EACH ONE. THERE IS OF COURSE SOME GREAT ARTWORK FROM GRAFFITTI ARTISTS THAT SHOULDN'T BE NEGLECTED. ATTUALMENTE ALL' INTERNO DELLA FABBRICA SI POSSONO VEDERE I RESTI DELLA MACCHINA FABBRICA GHIACCIO, E I NUMEROSISSIMI GRAFFITI CHE RICOPRONO L' INTERO VOLUME.



THERE ARE SOME PENDING PROJECTS FOR THE SITE BUT SINCE RESISTANCE IS LARGE, NOTHING SEEMS TO BE HAPPENING. VI SONO VARI PROGETTI DI DEMOLIZIONE E RICONVERSIONE DELL' EDIFICIO, MA DAL MOMENTO CHE VARIE E FORTI SONO LE PROTESTE CONTRO L' ABBATTIMENTO DELLA FABBRICA, NULLA SEMBRA ANCORA ACCADERE.

WHEN: BEFORE THE DEATH OF THE BUILDINGS

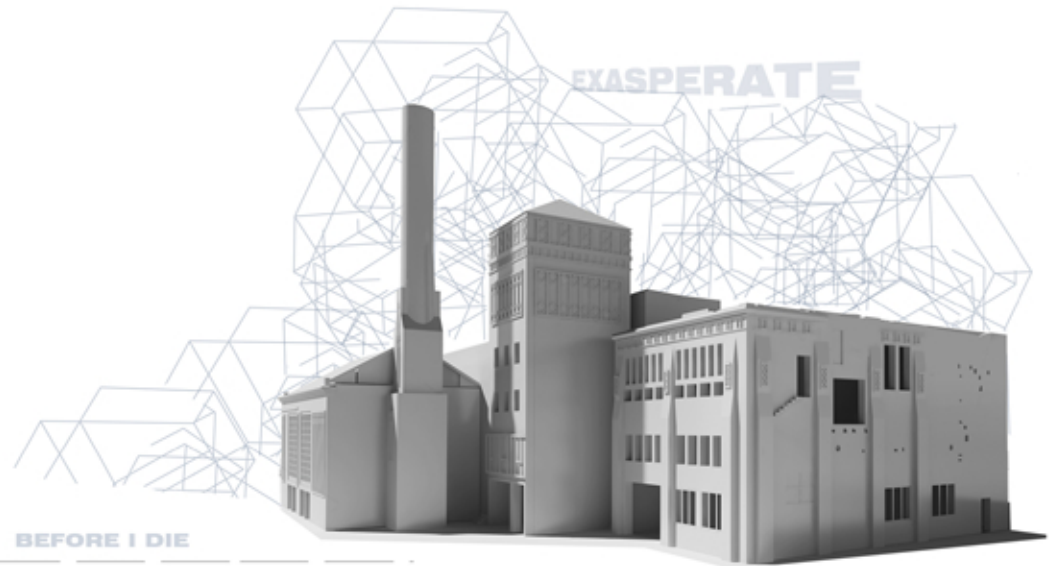

BEFORE I DIE



FUTURE

THE DEATH OF EISFABRIK
LA MORTE DELLA EISFABRIK

WHERE: FREE GROUND FLOOR



PLACE OF TRANSIT FREE

WHAT: DIFFERENT PRIMORDIAL INSTINCT DIFFERENT SET



ARCHITECTURE SUPPORT OF ART



- 1 WORD SETTING
- 2 LIGHT SETTING
- 3 SPACE SETTING
- 4 FORM SETTING

PROJECT

KEY WORDS: MAN - OBJECTS TO PUT TOGETHER - WOOD AND ROPE - FRAMEWORK

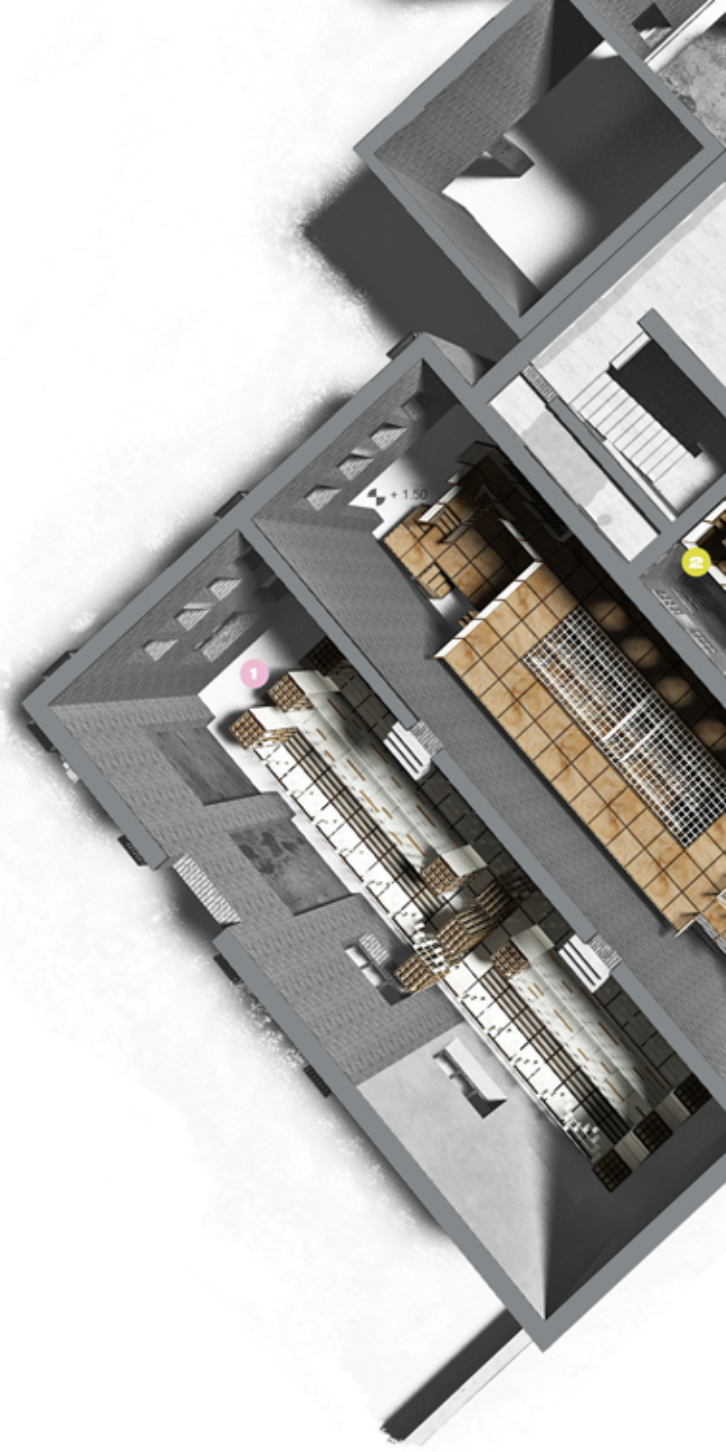
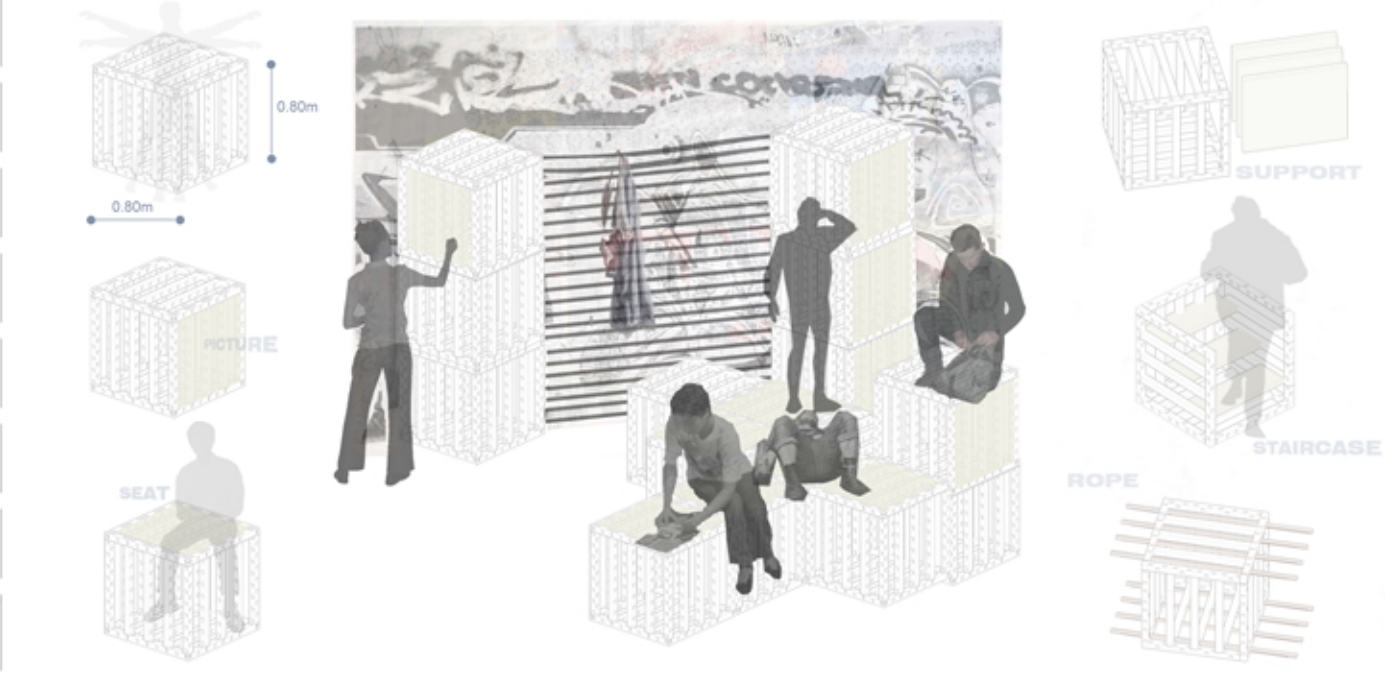

1 WRITING SETTING



2 LIGHT SETTING PATIO THE TOWER : FROM THE GROUND LEVEL TO THE ROOF



KEY WORDS: DELIMITED SPACE INSIDE THE BUILDING - SEE TROUGH

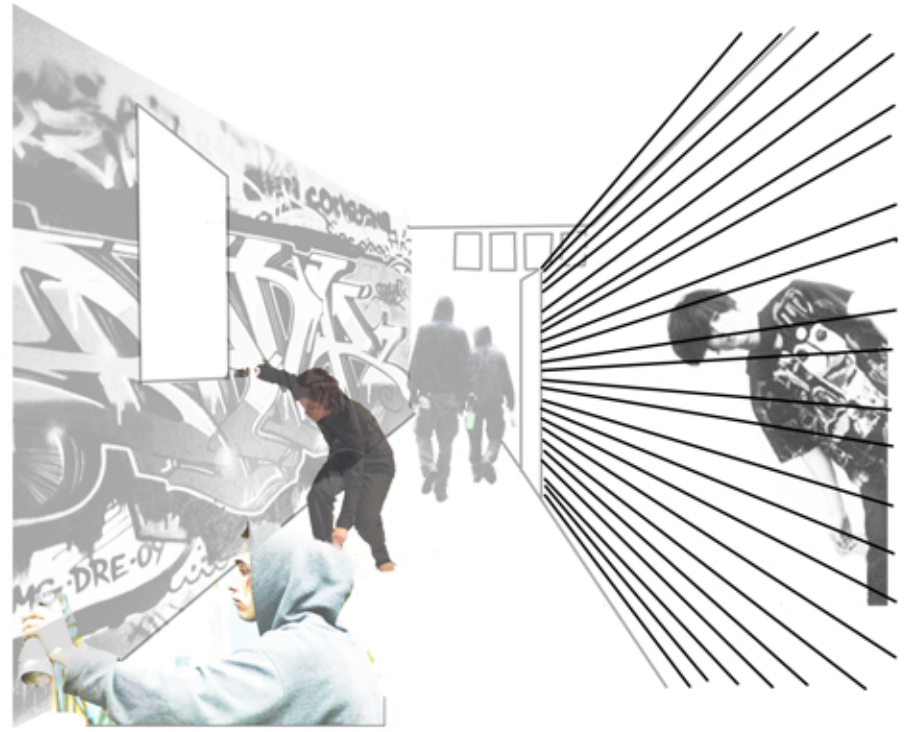

3 SPACE SETTING

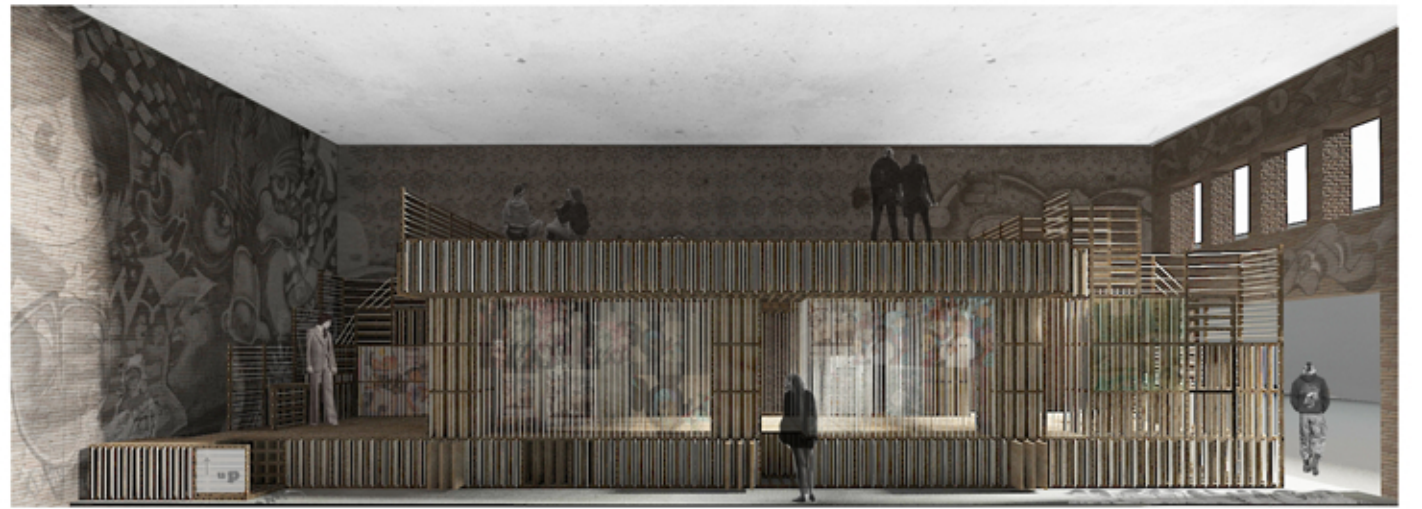
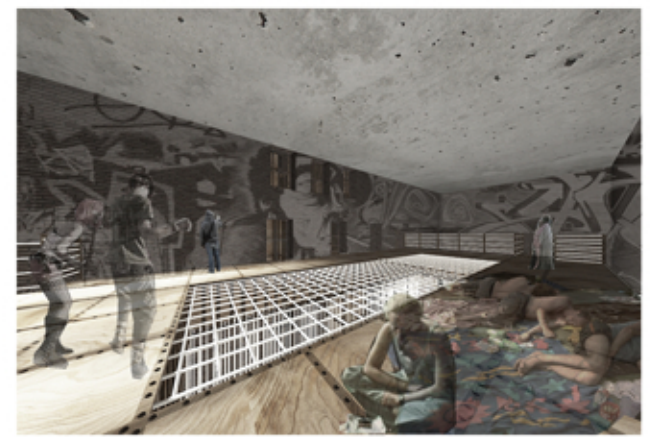
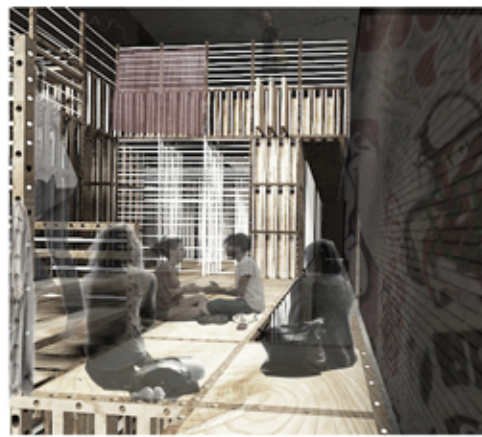

4 FORM SETTING



PLACE: BERLIN ICE FACTORY BETWEEN KOPERNIKERSTRASSE AND SPREE RIVER



FABRIK

THE EISFABRIK IS AN ABANDONED STRUCTURE SANDWICHED BETWEEN KOPERNIKERSTRASSE ON ONE SIDE, AND THE SPREE RIVER ON THE OTHER. THE EISFABRIK EXISTS NOT JUST AS AN ARTIFACT DIRECTLY REPRESENTING BERLIN'S INDUSTRIAL PAST, BUT ALSO AS A KIND OF POST-URBAN REPRESENTATION OF THE CITY'S IDENTITY TODAY.

CONCEPT

ARCHITECTURE FOR MAN



LIFE CYCLE



1938



1945



1985



2012



FUTURE

ON THE MAIN FLOOR OF THE FACTORY YOU'LL SEE THE BIG ICE MACHINES THAT MADE THE BASIC MAPPING. ALSO THERE ARE SMALLER ROOMS OF YOU GO UP TO THE FLOORS AND EXPLORE EACH ONE THERE IS OF COURSE SOME GREAT ARTWORK. PLEASE GRAB IT! ARTISTS THAT SHOULD BE SELECTED. ATTUALMENTE ALL INTERNO DELLA FABBRICA SI POSSONO VEDERE I RESTI DELLA ANTICHA FABBRICA DI SHAKOOL E I TRACCI DI ROSSOBA GRANTI CHE RISPONDONO L'INTERNO VISUALE.

THERE ARE SOME FRENCH PROJECTS FOR THE SITE BUT SINCE RESISTANCE IS LARGE, NOTHING SEEMS TO BE HAPPENING. VISIONI UN PROGETTO DI DEMOLIZIONE E RICOSTRUZIONE DELLA FABBRICA. MA DAL MOMENTO CHE UNO E PONTI SONO LE PROSPETTIVE CONTRO L'ABANDONAMENTO DELLA FABBRICA, NELLA SENZA ANCORA ACCORDI.

THE DEATH OF EISFABRIK LA MORTE DELLA EISFABRIK

WHY: BERLIN ICE FACTORY INSIDE CITY AND OUTSIDE SOCIETY

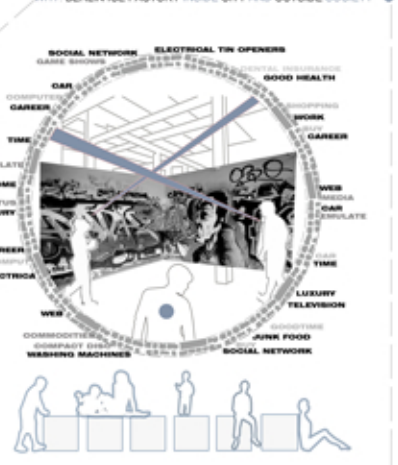

WHEN: BEFORE THE DEATH OF THE BUILDINGS

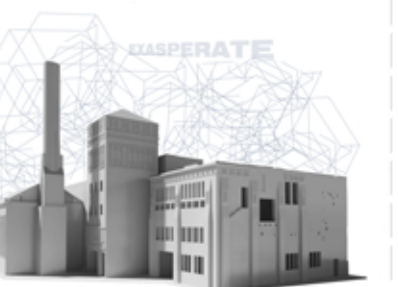

WHERE: FREE GROUND FLOOR



WHAT: DIFFERENT PRIMORDIAL INSTINCT DIFFERENT SET



PROJECT

KEY WORDS: MAN - OBJECTS TO PUT TOGETHER - WOOD AND ROPE - FRAMEWORK

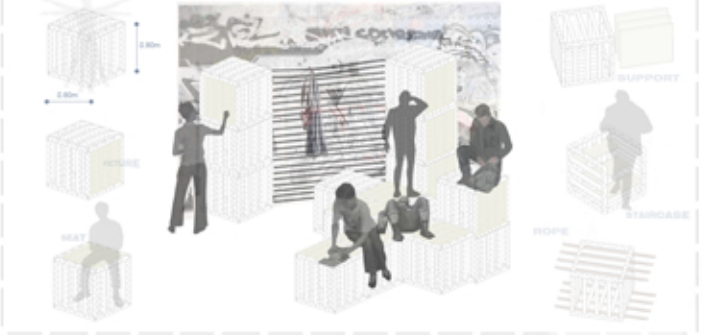

LIGHT SETTING PATIO: THE TOWER - FROM THE GROUND LEVEL TO THE ROOF

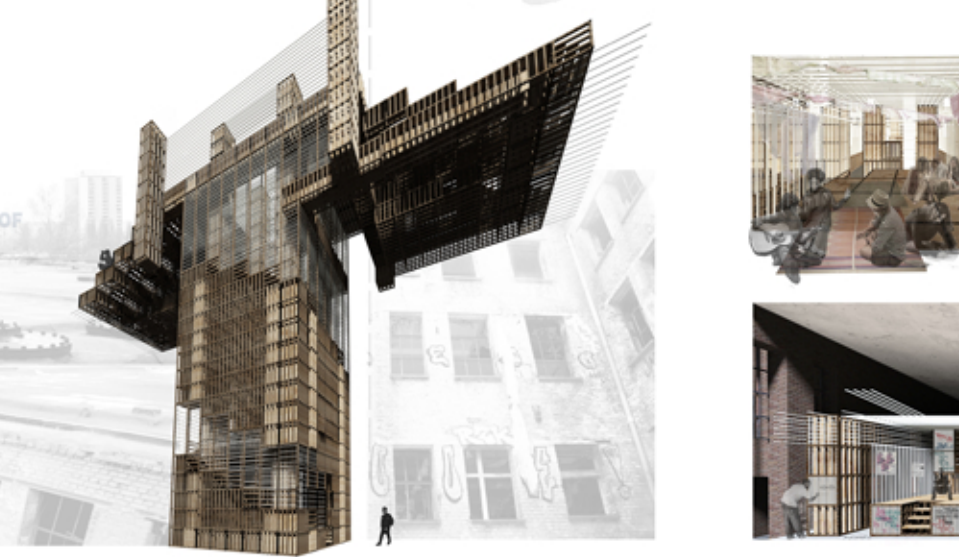

- WORD SETTING
- LIGHT SETTING
- SPACE SETTING
- FORM SETTING

KEY WORDS: DELIMITED SPACE INSIDE THE BUILDING - SEE TROUGH

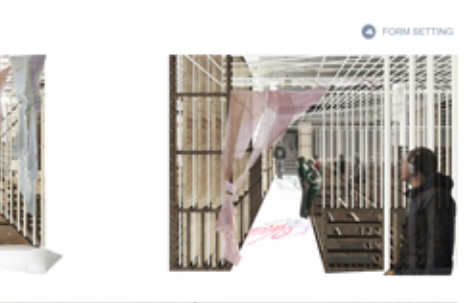
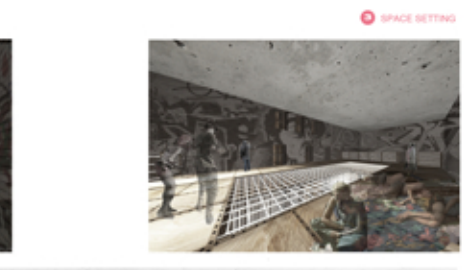

SPACE SETTING

FORM SETTING

VIEW ON THE ROOF

