

UNICAM  
Università di Camerino  
1936

Laureando: Monica Pomili

TITOLO TESI: Grottammare: Parco Urbano del Quartiere Stazione  
 Relatore: prof. Raffaele Mennella  
 Correlatore: prof. Umberto Cao - arch. Stefano Novelli

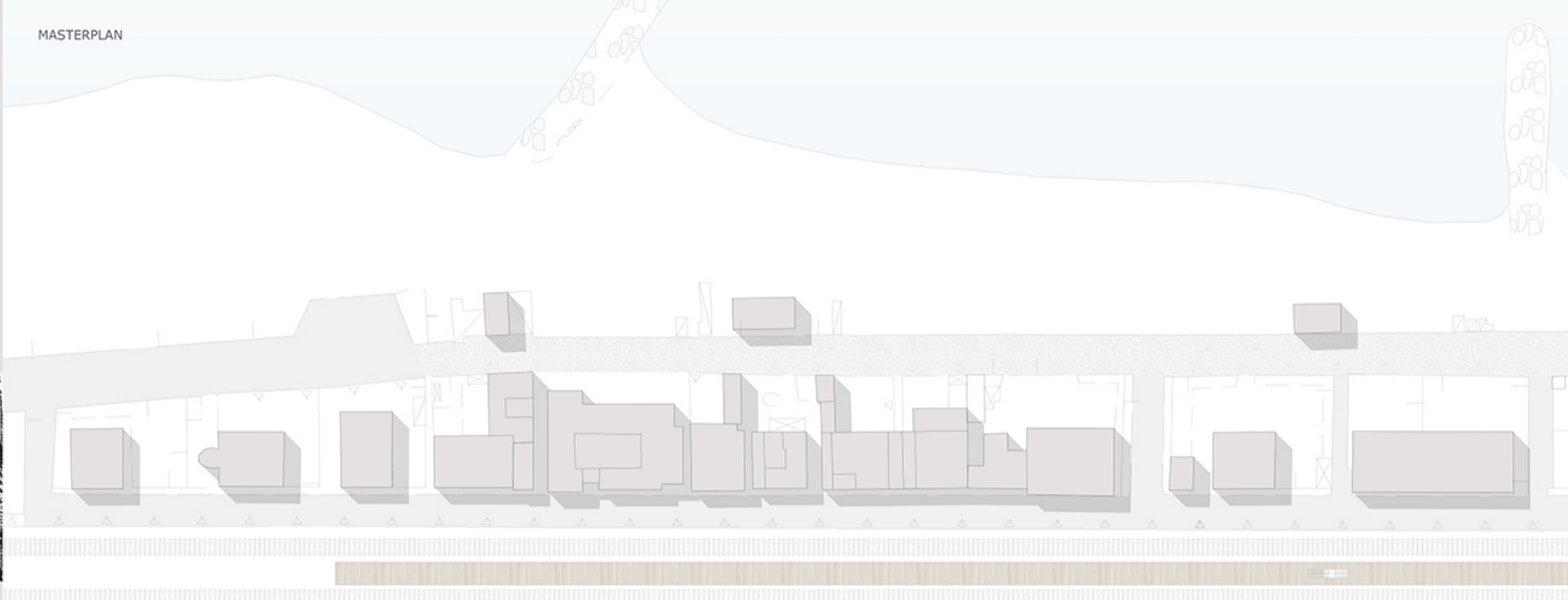

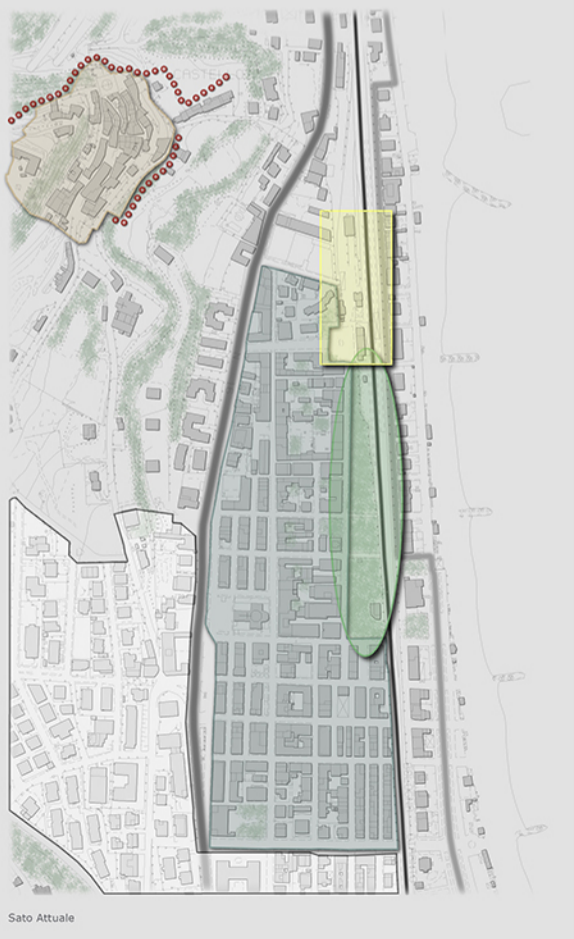
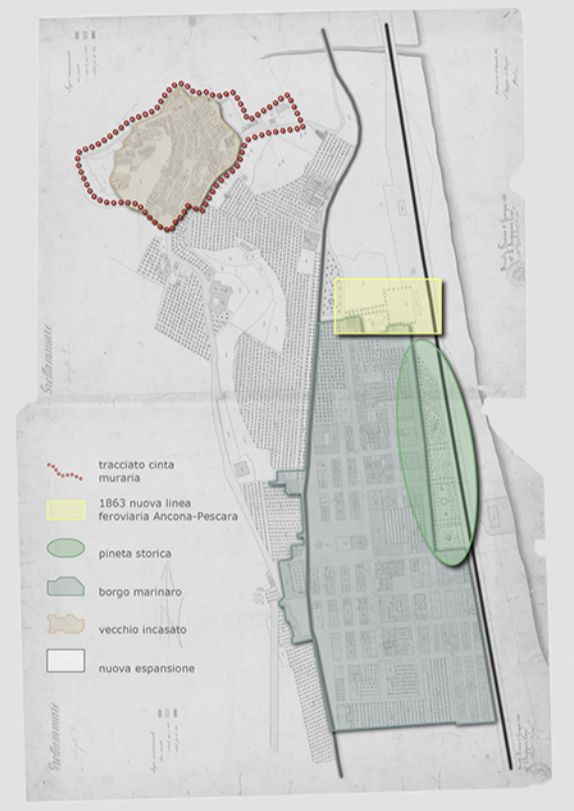
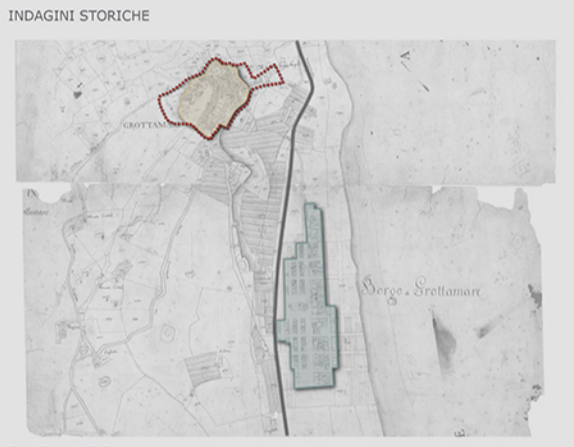
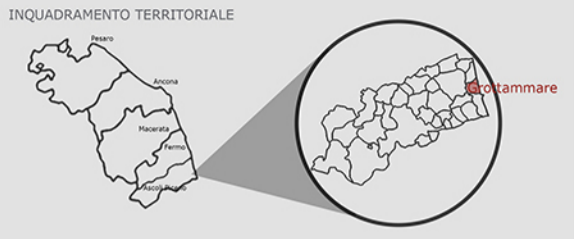
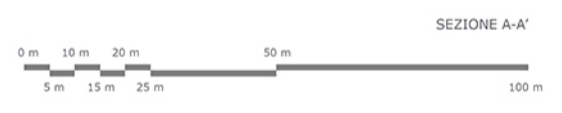
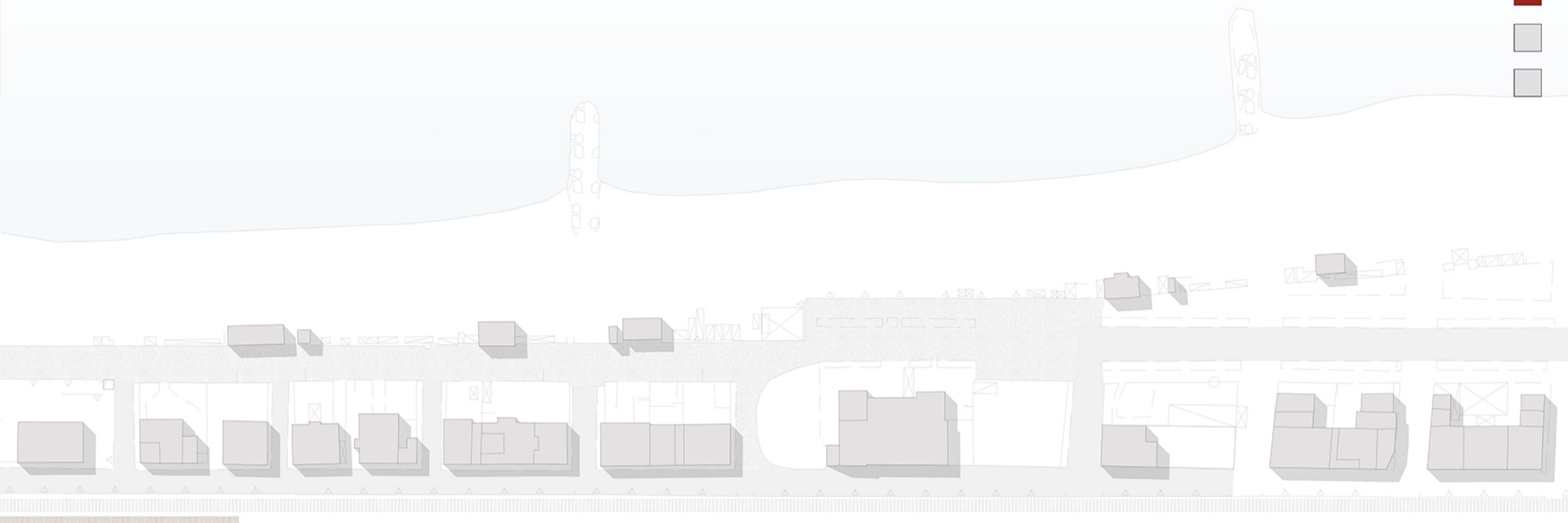
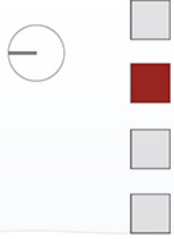



- LEGENDA
- barriera infrastrutturale
  - discontinuità aree verdi
  - vuoto urbano
  - × edifici abbandonati

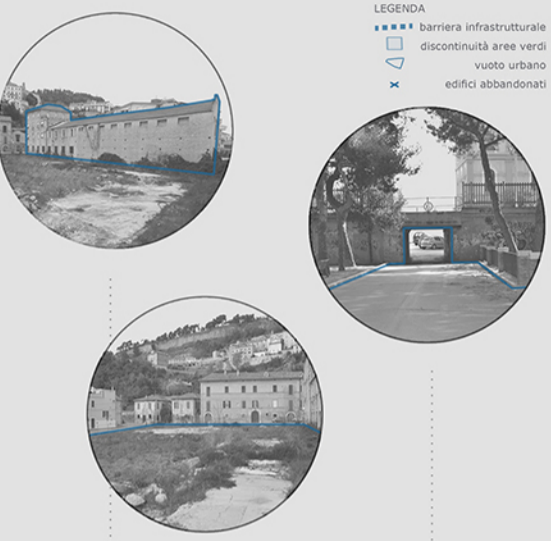

SEZIONE A-A

1. SALA DA PRANZO
2. CUCINA
3. DISPENSA
4. AULA
5. DORMITORIO
6. ZONA CAMBIO E WC
7. HALL DI INGRESSO
8. UFFICIO DEL DIRETTORE
9. INGRESSO PRINCIPALE
10. CORRIDOIO DI SERVIZIO
11. TEATRO

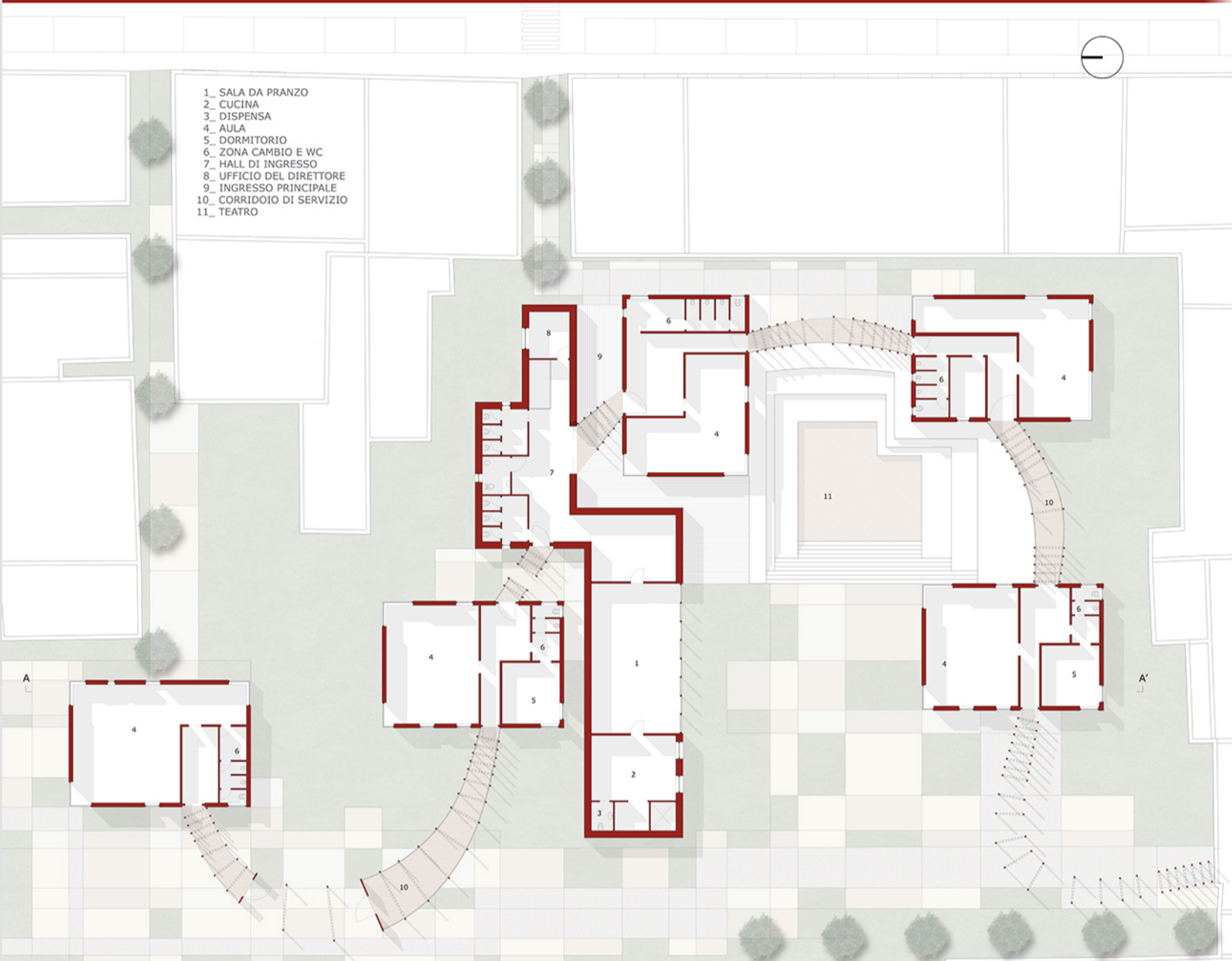

PIANTA SCALA 1:200

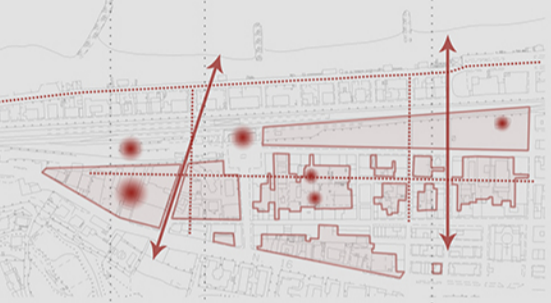

- LEGENDA
- collegamenti
  - potenziamento ciclopedonale
  - rafforzamento aree verdi
  - riconversione difici

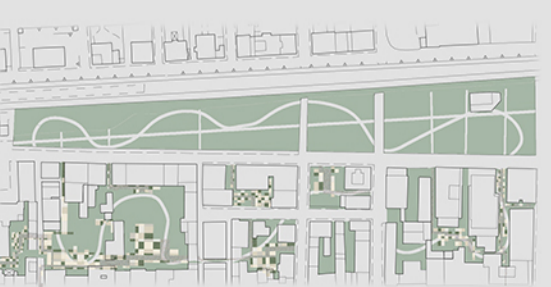

- 1\_ CENTRO ARTISTICO RICREATIVO
- 2\_ BIKE SHARING
- 3\_ BIGLIETTERIA AUTOBUS
- 4\_ SALA D'ATTESA
- 5\_ WC
- 6\_ SALA D'ATTESA
- 7\_ BIGLIETTERIA STAZIONE
- 8\_ BOOKSHOP
- 9\_ TERRAZZA PANORAMICA
- 10\_ BAR
- 11\_ SOSTA AUTOBUS

